



PRICE PUMP CO.

XT/XL PARTS LIST

Effective: May 2004
Page 1 of 2



For Sizes:

- 1 x 1½ - 6
- 1½ x 2 - 6 (Threaded Only)
- 1½ x 3 - 6 (Flanged Only)
- 2 x 3 - 6

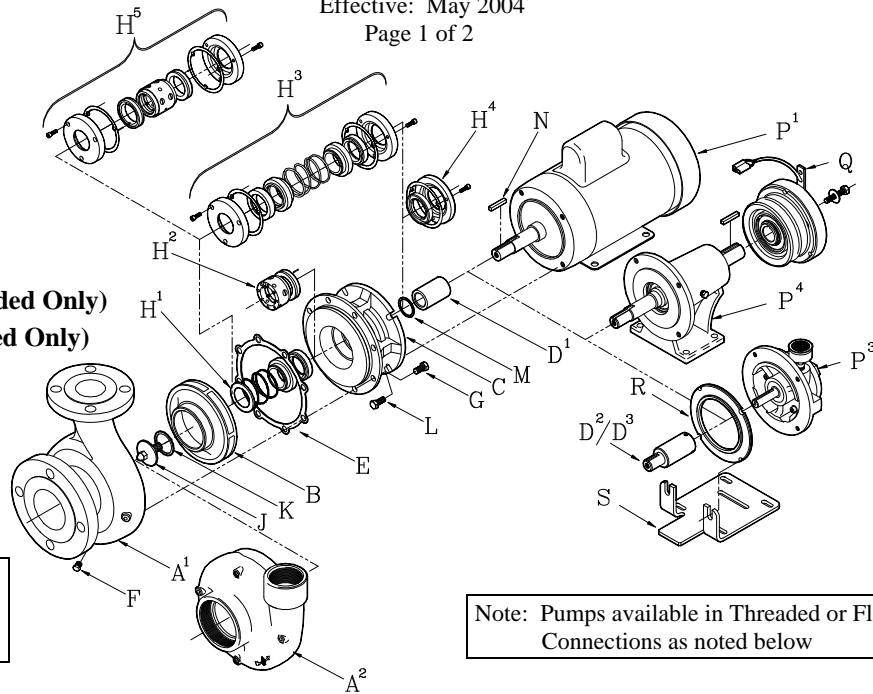

AI = All Iron
AB = All Bronze
BF = Bronze Fitted
SS = Stainless Steel

Note: Pumps available in Threaded or Flanged Connections as noted below

	<u>AI Threaded</u>	<u>BF Threaded</u>	<u>AB Threaded</u>	<u>SS Threaded</u>	<u>SS Flanged</u>
A. Volute					
1 x 1-1/2 - 6 (XT100 Threaded, XL100 Flanged)	2601	2601	2603	2629	2605
1-1/2 x 2 - 6 (XT150 Threaded)	2607	2607	2609	2626	
1/2 x 3 - 6 (XL150 Flanged)					2611
2 x 3 - 6 (XT200 Threaded, XL200 Flanged)	2613	2613	2615	2627	2617
B. Impeller Specify diameter **					
1 x 1-1/2 - 6 (XT100 Threaded, XL100 Flanged)	2602-dia	2604-dia	2604-dia	2606-dia	2606-dia
1-1/2 x 2 - 6 (XT150 Threaded)	2608-dia	2610-dia	2610-dia	2612-dia	
1-1/2 x 3 - 6 (XL150 Flanged)					2612-dia
2 x 3 - 6 (XT200 Threaded, XL200 Flanged)	2614-dia	2616-dia	2616-dia	2618-dia	2618-dia
Note: For Dbl seal add DS (Sample: 2614 DS -dia)					
C. Bracket (std)	0131	0131	0132	0979	0979
Double Seal	0131-1	0131-1	N/A	0979-1	0979-1
Single Flush	0131-2	0131-2	0132-2	0979-2	0979-2
Quench	0131-3	0131-3	N/A	0979-3	0979-3
Internal Flush	0131-4	0131-4	N/A	0979-4	0979-4
Bracket for 213/215 JM	3405	3405	N/A	3388	3388
O-ring	3405-0	3405-0	N/A	N/A	N/A
Double Seal	2405-1	3405-1	N/A	3388-1	3388-1
Single Flush	3405-2	3405-2	N/A	3388-2	3388-2
Quench	3405-3	3405-3	N/A	3388-3	3388-3
Internal Flush	3405-4	3405-4	N/A	3388-4	3388-4
Internal Flush w/ Quench	3405-5	3405-5	N/A	3388-5	3388-5
D ¹ . Shaft Sleeve (for std JM motor)	0127	0127	0127	0127	0127
D ² . Stub Shaft 5/8" ID (56C) opt	0329-1	0329-1	0329-1	0329-1	0329-1
D ³ . Stub Shaft 7/8" ID (143TC/145TC/182C/184C)					
optional (not shown)	0328-1	0328-1	0328-1	0328-1	0328-1
E. Volute Gasket	0124 (Syn Fiber)	0124 (Syn Fiber)	0124 (Syn Fiber)	0301 (PTFE)	0301 (PTFE)
F. Pipe Plug (2 rqd Threaded, 1 rqd Flanged)	0557	0557	0558	0559	0559
G. Volute Bolts (8 rqd)	0583	0583	0587	0724	0724
H ¹ . T.21 Single Seal/Seat	0121 (std B*)	0121 (std B*)	0121 (std B*)	0122 (std V*)	0122 (std V*)

B* = Buna

V* = Fluorocarbon

**For Double Seal Impellers (add "DS" to Impeller P/N For Example: 2602DS)

Price® Pump Company

21775 8th Street East ♦ Sonoma, CA 95476-0329 ♦ (707) 938-8441 ♦ Fax (707) 938-0764

XT/XL PARTS LIST

Effective: May 2004

Page 2 of 2

		<u>All Models</u>			<u>All Models</u>
H ² .	T.9 PTFE Single Seal/Seat (opt)	0123	M.	Sleeve Gasket, PTFE	0245
	Seat Pin T.9 (not shown)	0890	N.	Impeller Shaft Key	0135
H ³ .	T.21 Double Seal/Seat (opt)	Specify P/N	P1.	JM Motor	Specify P/N
	Double Seal Plate (2 rqd)	0309	P2.	'C' Face Motor (not shown)	Specify P/N
	Plate Gasket, PTFE (2 rqd)	0505		Base Plate (not shown)	0199
	Plate Bolts (6 rqd)	0977	P3.	Air Motor	Specify P/N
H ⁴ .	Seal Quench (opt):		P4.	Power Frame	5480
	Buna Lip Seal	0756	Q.	12 Volt Clutch (opt)	1983
	Fluorocarbon Lip Seal	0757		Key for Clutch (2 ea)	0136
	PTFE Lip Seal	0758		Lockbolt for Clutch	0567
	Lip Seal Plate	0309-2		Lockbolt Washer for Clutch	0564
	Plate Gasket, PTFE	0505	R.	Extension Plate for 5/8" & 7/8" Shafts	3690
	Plate Bolts (3 rqd)	0977	S.	Base	0199
H ⁵ .	T.9 PTFE Double Seal/Seat (opt)	0670			
	Double Seal Plate (2 rqd)	0309-1			
	Plate Gasket, PTFE (2 rqd)	0505			
	Plate Bolts (6 rqd)	0977			
	Seat Pin T.9 (2 rqd not shown)	0890			
J.	Impeller Lockdown	0978			
K.	Lockdown Gasket, PTFE	0245			
L.	Motor Bolts				
	All Bronze pumps (4 rqd)	0587			
	Stainless Steel pumps (4 rqd)	0593			
	AI & BF pumps (4 rqd) and	0593			
	order Washers (4 rqd)	1137			
	Motor Bolts for 3405 & 3388 brackets				
	All Bronze pumps	N/A			
	Stainless Steel pumps (4req)	1189			
	AI & BF pumps (4 req) and	1189			
	order Washers (4 req)	1199			
	Motor Bolts for 5/8" & 7/8" Shafts				
	All pumps (Both below bolts rqd)				
	Top motor bolts (2 rqd)	60-029-00			
	Bottom motor bolts (2 rqd)	60-024-00			
	AI & BF also need				
	Washers (4 req.)	1199			

XL/XT Repair Parts Kits

AI, AB, BF P/N 0659 Syn. Fiber Gasket - SS Shaft Sleeve - Sleeve Gasket - Loctite - Imp. Lockdown Gasket
 SS P/N 1019 PTFE Gasket - SS Shaft Sleeve - Sleeve Gasket - Loctite - Imp. Lockdown Gasket

Note: Seal/seat must be ordered in addition to repair kit.

Options: 1½" T.21 & T.9 Single & Double.

(XTXLplist.doc rev B)

Price® Pump Company

21775 8th Street East ♦ Sonoma, CA 95476-0329 ♦ (707) 938-8441 ♦ Fax (707) 938-0764